



INSTALLATION MANUAL

GTX12V320A-E2107-CS200-UL

NeverDie® Compact Series 200 Internal BMS



IMPORTANT SAFETY GUIDELINES

This guide contains important safety instructions for the GTX12V320A-E2107-CS200-UL Battery System that must be followed during installation procedures. Completely read this manual and become familiar with all system components before attempting installation. Save this installation manual for future reference.

The following symbols and messages are used to identify potential hazards or to clarify the procedure.



The **CAUTION** symbol indicates a hazardous situation which, if not avoided, could result in moderate or minor injury.



The **DANGER** symbol indicates a hazardous situation which, if not avoided, will result in death or serious injury.

SAFETY INFORMATION

1. Before using the Battery System, read all instructions and cautionary markings on the unit, the BMS, and all appropriate sections of this manual.
2. The information in this manual is intended for qualified personnel. Qualified personnel have training, knowledge, and experience in:
 - Selecting and using Personal Protective Equipment (PPE).
 - Installing electrical equipment.
 - Applying all applicable local and national installation codes.
 - Analyzing and reducing the hazards involved in performing electrical work.
3. Use of accessories not recommended or sold by the manufacturer may result in a risk of fire, electric shock, or injury to persons.
4. To avoid a risk of fire and electric shock, make sure that existing wiring is in good condition and that wire is not undersized. Do not operate the battery system with damaged or substandard wiring.
5. Do not operate the battery system if it has been damaged in any way.
6. This unit does not have any user-serviceable parts. Do not disassemble the battery system except where noted for connecting wiring and cabling. Attempting to service the unit yourself may result in a risk of electrical shock or fire. Internal cells remain charged after all power is disconnected.
7. To reduce the chance of short-circuits, always use insulated tools when installing or working with this equipment.
8. Remove personal metal items such as rings, bracelets, necklaces, and watches when working with electrical equipment.



HAZARD OF ELECTROLYTE VAPOR

- The battery may emit a non-toxic pressurized electrolyte vapor if punctured.
- Electrolyte vapor may cause temporary minor breathing congestion.
- Electrolyte vapor can decrease visibility in closed compartments.



HAZARD OF ELECTRIC SHOCK, EXPLOSION, OR ARC FLASH

- Apply appropriate personal protective equipment (PPE) and follow safe electrical work practices.
- Always turn OFF all equipment connected to the system in addition to turning OFF the power switch provided on the system to isolate the batteries from other electrical circuits, before performing any repairs or maintenance on the system.
- Do not operate the system if it has received a sharp blow, been dropped, has cracks or openings in the enclosure.
- Do not disassemble any part of the system. Internal cells remain charged after all power is disconnected.
- Do not operate the system with damaged or substandard wiring.
- Always use proper wire sizes to connect the system to inverters, chargers or other equipment.
- Voltage is present at the connector and output terminals. Always ensure that the BMS output terminals have the insulated protective boots in place.
- Always use crimped connections to connect to the output terminals.
- Always use a properly rated voltage sensing device to confirm all circuits are de-energized.



HAZARD OF HEAVY EQUIPMENT

- Use two people to lift and mount the battery.
- Always use proper lifting techniques during installation to prevent injury.
- Do not lift the battery by its power or signal wires as they will become damaged.

If the system is operated outside of its limits and/or used in combination with non-original components without authorization, the warranty is void.

Do not expose this unit to direct sunlight, external heat sources or submersion in any liquid. This product is designed for closed compartment use only. Damage to any part of the battery system caused from direct sunlight, external heat sources or submersion in any liquid will not be covered by the product warranty.

The Battery is tested to comply with UN DOT 38.3, the testing requirement for Lithium Batteries per Part III; of the UN Recommendations on the TRANSPORT OF DANGEROUS GOODS (Manual of Tests and Criteria, Fifth revised edition); [ST/SG/AC.10/11/Rev.5].

This Battery contains no mercury and is RoHS Compliant. Please consult your local municipal authority for proper disposal.

CONSIGNES DE SÉCURITÉ IMPORTANTES

Ce guide contient des instructions de sécurité importantes pour le système de batterie GTX12V320A-E2107-CS200-UL qui doivent être suivies pendant les procédures d'installation. Lisez entièrement ce manuel et familiarisez-vous avec tous les composants du système avant de tenter l'installation. Conservez ce manuel d'installation pour référence future.

Les symboles et messages suivants sont utilisés pour identifier les dangers potentiels ou pour clarifier la procédure.



Le mot ATTENTION indique une situation potentiellement dangereuse, laquelle, si elle n'est pas évitée, pourrait entraîner des blessures mineures ou modérées.



Le mot DANGER indique une situation dangereuse imminente, laquelle, si elle n'est pas évitée, entraînera de graves blessures, voire la mort.

INFORMATION SUR LA SÉCURITÉ

1. Avant d'utiliser le système de batterie, lisez toutes les instructions et les avertissements sur l'unité, le BMS et toutes les sections appropriées de ce manuel.
2. Les informations contenues dans ce manuel sont destinées au personnel qualifié. Le personnel qualifié possède une formation, des connaissances et une expérience en:
 - Sélection et utilisation des équipements de protection individuelle (EPI).
 - Installation d'équipements électriques.
 - Appliquer tous les codes d'installation locaux et nationaux applicables.
 - Analyser et réduire les risques liés à l'exécution des travaux électriques.
3. L'utilisation d'accessoires non recommandés ou vendus par le fabricant peut entraîner un risque d'incendie, de choc électrique ou de blessures corporelles..
4. Pour éviter tout risque d'incendie et d'électrocution, assurez-vous que le câblage existant est en bon état et que le fil n'est pas sous-dimensionné. Ne pas faire fonctionner le système de batterie avec un câblage endommagé ou de qualité inférieure.
5. N'utilisez pas le système de batterie s'il a été endommagé de quelque manière que ce soit.
6. Cet appareil ne contient aucune pièce réparable par l'utilisateur. Ne démontez pas le système de batterie, sauf indication contraire pour le câblage et le câblage. Tenter de réparer l'appareil vous-même peut entraîner un risque d'électrocution ou d'incendie. Les cellules internes restent chargées une fois que toute l'alimentation est coupée.
7. Pour réduire les risques de courts-circuits, utilisez toujours des outils isolés lors de l'installation ou de l'utilisation de cet équipement.
8. Retirez les objets métalliques personnels tels que bagues, bracelets, colliers et montres lorsque vous travaillez avec des équipements électriques.



RISQUE DE VAPEUR D'ÉLECTROLYTE

- Le batterie peut émettre une vapeur d'électrolyte sous pression non toxique s'il est perforé.
- Les vapeurs d'électrolyte peuvent causer une congestion respiratoire mineure temporaire.
- La vapeur d'électrolyte peut diminuer la visibilité dans les compartiments fermés.



RISQUE DE CHOC ÉLECTRIQUE, D'EXPLOSION OU D'ARC ÉLECTRIQUE

- Appliquer un équipement de protection individuelle (EPI) approprié et suivre des pratiques de travail électrique sûres.
- Éteignez toujours tous les équipements connectés au système en plus de désactiver l'interrupteur d'alimentation fourni sur le système pour isoler les batteries des autres circuits électriques, avant d'effectuer toute réparation ou maintenance sur le système.
- N'utilisez pas le système s'il a reçu un coup violent, s'il est tombé, s'il présente des fissures ou des ouvertures dans le boîtier.
- Ne démontez aucune pièce du système. Les cellules internes restent chargées une fois que toute l'alimentation est déconnectée.
- N'utilisez pas le système avec un câblage endommagé ou de qualité inférieure.
- Utilisez toujours des câbles de taille appropriée pour connecter le système aux onduleurs, chargeurs ou autres équipements.
- Une tension est présente au niveau du connecteur et des bornes de sortie. Assurez-vous toujours que les bornes de sortie BMS ont les bottes de protection isolées en place.
- Utilisez toujours des connexions serties pour vous connecter aux bornes de sortie.
- Utilisez toujours un dispositif de détection de tension correctement évalué pour confirmer que tous les circuits sont hors tension.



RISQUE D'ÉQUIPEMENT LOURD

- Utilisez deux personnes pour soulever et monter le batterie.
- Utilisez toujours des techniques de levage appropriées lors de l'installation pour éviter les blessures.
- Ne soulevez pas le batterie par ses fils d'alimentation ou de signal car ils seront endommagés.

Si le système est utilisé en dehors de ses limites et / ou utilisé en combinaison avec des composants non originaux sans autorisation, la garantie est nulle.

N'exposez pas cet appareil à la lumière directe du soleil, à des sources de chaleur externes ou à une immersion dans un liquide. Ce produit est conçu pour une utilisation à compartiment fermé uniquement. Les dommages à toute partie du système de batterie causés par la lumière directe du soleil, des sources de chaleur externes ou une submersion dans un liquide ne seront pas couverts par la garantie du produit.

Le batterie et le BMS sont testés pour se conformer à UN DOT 38.3, l'exigence de test pour les batteries au lithium selon la partie III; des Recommandations des Nations Unies sur le TRANSPORT DES MARCHANDISES DANGEREUSES (Manuel d'épreuves et de critères, cinquième édition révisée); [ST/SG/AC.10/11/Rev.5].

Ce batterie ne contient pas de mercure et est conforme RoHS. Veuillez consulter les autorités municipales locales pour une élimination appropriée.

TABLE OF CONTENTS

| | |
|--------------------------------|----|
| Notice of Copyright | 6 |
| Safety..... | 6 |
| Overview | 6 |
| 1. System Components..... | 7 |
| 2. System Specifications | 9 |
| 3. System Installation..... | 10 |
| 4. System Operation..... | 13 |
| Contact Information | 14 |

NOTICE OF COPYRIGHT

GTX12V320A-E2107-CS200-UL User Guide Copyright © 2023 all rights reserved. No part of this document may be reproduced in any form without the express consent of Lithionics Battery®, Clearwater, FL 33765 USA. Lithionics Battery® reserves the right to revise this document and make periodic changes to the contents without notice.

SAFETY

- All electrical work shall be performed in accordance with local and national electrical codes.
- Assume that voltage is present at the battery terminals, use insulated tools and gloves while working on the system.
- Always turn OFF equipment connected to the battery in addition to turning OFF the Power button on the battery to isolate it from other electrical circuits before performing any repairs, maintenance or diagnosis on the system.
- Always use proper wire sizes to connect the system to inverters, chargers, or other equipment.
- Always use crimped connections to connect to the battery terminals.
- Read and follow the inverter, charger, or other equipment manufacturers safety precautions prior to connecting the battery to that equipment.
- Always use charging equipment compatible with Lithium Iron Phosphate battery chemistry. See battery charging section below.

OVERVIEW

This Guide is intended to be used by qualified individuals in the installation of the GTX12V320A-E2107-CS200-UL battery system.

1. SYSTEM COMPONENTS

1.1 Components

- GTX12V320A-E2107-CS200-UL Battery
- Accessory Harness (#75-H1FCR-CS2-UL)
- DC Circuit Breaker (Sensata #JLE-1-41340-250)
- Protective DC Terminal Covers (Red & Black, not shown)
- Two Sets of M8x12x1.25mm Bolts and Lock Washers for the Terminals

Figure 1: Components

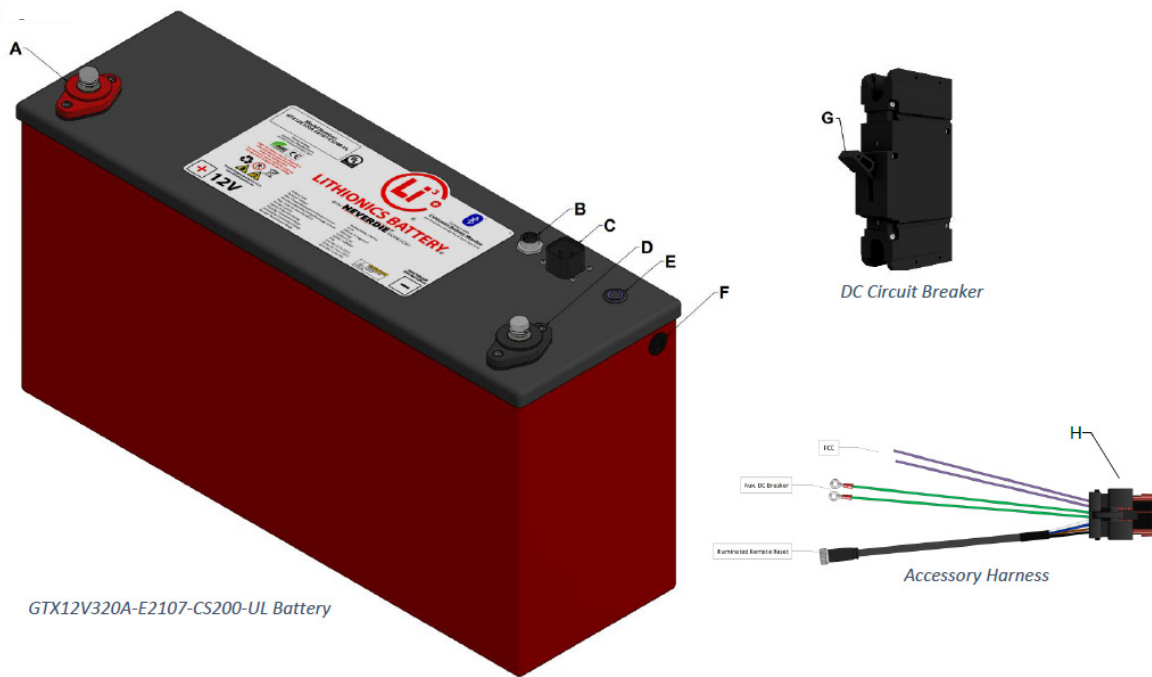

| FEATURE | DESCRIPTION |
|-----------------------|--|
| A Positive Terminal | Brass, Nickel Plated, M8-1.25 Thread, Torque to 108-132in-lbs (12.2 - 14.9N-m) |
| B OptoLoop+ Connector | RV-C CANBus Data, Remote Display Unit |
| C Accessory Connector | FCC, Remote Power Button, Auxiliary DC Breaker |
| D Negative Terminal | Brass, Nickel Plated, M8-1.25 Thread, Torque to 108-132in-lbs (12.2 - 14.9N-m) |
| E Power Button | Power Button with Status Light |
| F Vent | Pressure Balancing Vent |
| G DC Circuit Breaker | Auxiliary DC Circuit Breaker for UL Compliance |
| H Accessory Harness | Enables Integration of FCC, Remote Power Button, and Auxiliary DC Breaker |

1.2 DC Circuit Breaker

The Auxiliary DC Breaker is one of the components required that enables the system to be a UL1973 Listed system. UL1973 Listing represents a high degree of safety tested by Underwriter Laboratories.

The battery operates by using the Auxiliary DC Breaker as a redundant disconnect device if the battery must be isolated from its loads. The Auxiliary DC Breaker replaces the need for a fuse and serves as a manual disconnect for storage and maintenance via its toggle switch.

The required and included DC breaker model is the Sensata Circuit Breaker #JLE-1-41340-250. The 2 control wires for this feature are wired via the battery accessory connector.

Figure 2:
Circuit Breaker

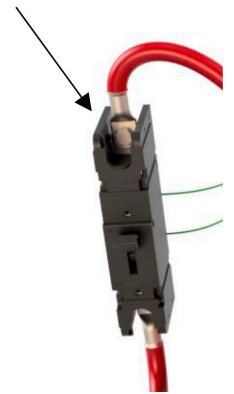

1.3 Accessory Harness

The Accessory Harness connects to the battery and is used to access the BMS's ported features. This allows implementation of the features shown below.

Figure 3: Accessory Harness



2. SYSTEM SPECIFICATIONS

2.1 Operating Specifications

Table 1: Operating Specifications

| | |
|--|--|
| System Model | GTX12V320A-E2107-CS200-UL |
| Capacity | 320Ah |
| Nominal Voltage | 12.8V |
| Recommended Charging Voltage | 14.4V |
| Maximum Charging Voltage | 14.8V @ 200A |
| Over-discharge Voltage Protection | 10.0V @ 230A |
| Standard Charging Current | 150A |
| Maximum Charging Current | 200A |
| Charge Termination Current | 10A |
| Standard Discharging Current/Load | 150A |
| Maximum Discharge Current/Load | 230A |
| System Impedance at Terminals | ≤ 2.20mΩ |
| Bolted Fault Current at Nominal Voltage (N2) | 5818A |
| Maximum Charging Temperature Range (N1) | 32 to 131°F (0 to 55°C) |
| Maximum Discharging Temperature Range (N1) | -4 to 131°F (-20 to 55°C) |
| Battery Dimensions | 20.3" x 6.4" x 10.0" (516 x 163 x 254mm) |
| Battery Weight | 68lb (30.8kg) |

Notes for Table 1: (N1) Maximum charging and discharging rates apply depending upon the ambient temperature and duty cycle of the system. UL1973 tests of maximum charge and discharge current were performed at 25°C/77°F. (N2) "Bolted Fault Current" per NFPA-70E. See section 1.2 for details.

2.2 Arc Flash Energy Specifications

An arc flash is the light and heat produced from an electric arc supplied with sufficient electrical energy to cause substantial damage, harm, fire, or injury.

- An example of an arc flash event could be a direct short circuit caused by a metallic object such as a tool bridging between the positive and negative of an energized circuit.
- Table 2 quantifies the hazard level of arc flash energy that each battery system is capable of producing.

Table 2: Arc Specifications

| | |
|---|---------------------------|
| TARC= 80MS CIRCUIT BREAKER CLEARING TIME | |
| Configuration | GTX12V320A-E2107-CS200-UL |
| Vsys | 12.8 |
| Impedance mΩ | 2.20 |
| Ibf, calc. | 5818 |
| Iarc | 2909 |
| IEm cal/cm ² | 0.360 |
| 3x IEm cal/cm ² | 1.079 |
| Distance where IEm=1.2 (Arc Boundary), inches. | 9 |
| Hazard level | 0 |

Per NFPA 70E D.5.1 "Maximum Power Method"

$I_{arc} = 0.5 \times I_{bf}$ • $I_{Em} = 0.01 \times V_{sys} \times I_{arc} \times T_{arc} / D^2$ (Arc Flash Energy)

Table 3: Hazard/risk classification as per NFPA 70E-2000

| CATEGORY | ENERGY LEVEL | TYPICAL PPE EXAMPLES |
|----------|------------------------|---|
| 0 | N/A | Non-melting, flammable materials (e.g., untreated cotton, wool, rayon, etc.) |
| 1 | 5 cal/cm ² | FR shirt and FR pants |
| 2 | 8 cal/cm ² | Cotton underwear plus FR shirt and pants |
| 3 | 25 cal/cm ² | Cotton underwear plus FR shirt and pants plus FR coverall |
| 4 | 40 cal/cm ² | Cotton underwear plus FR shirt and pants plus double layer switching coat and pants |

2.3 Manufacturing Date Code Format

- MMDDYYYY001
 - MM: Month of Manufacture
 - DD: Day of that Month
 - YYYY: Year of Manufacture
 - 001: Sequence of Battery Produced on That Day
- Example: 01012020001 = manufactured on January 1, 2020 and it was the first battery produced on that day.

3. SYSTEM INSTALLATION

3.1 Circuit Breaker

- The battery system must be operated with the included circuit breaker. The model listed in this document was evaluated and tested by Underwriter Laboratories. The circuit breaker is to be provided downstream of the battery on the positive side before the load or supply in all cases. The use of any other circuit breaker voids the UL Listing of the model.
- The circuit breaker must be installed into an enclosure with a NEMA Type 4 rating or better, see Reference 1 and Figure 4.
 - Lithionics Battery can supply a pre-made mounting enclosure which can be ordered under part number 41-206.
- The circuit breaker must NOT be installed with the handle/lever facing up or down, see the Permitted Orientations in Figure 5.
- Use 10-32 screws to mount the circuit breaker into the enclosure. The screw depth into the circuit breaker (not including the enclosure material thickness) must be within .230 to .315 max. Torque the 10/32 screws between 10-12 Inch Pounds.



Part # 41-206

Reference 1: Enclosure Rating

| Enclosure Rating | NEMA National Electrical Manufacturers Association (NEMA Standard 250) | UL Underwriters Laboratories, Inc. (UL50 and UL 508) |
|------------------|---|---|
| Type 4 | Indoor or outdoor use to provide a degree of protection to personnel against access to hazardous parts; to provide a degree of protection of the equipment inside the enclosure against ingress of solid foreign objects (falling dirt and windblown dust); to provide a degree of protection with respect to harmful effects on the equipment due to the ingress of water (rain, sleet, snow, splashing water, and hose directed water); and that will be undamaged by the external formation of ice on the enclosure. | Indoor or outdoor use to provide a degree of protection to personnel against incidental contact with the enclosed equipment; to provide a degree of protection against falling dirt, rain, sleet, snow, windblown dust, splashing water, and hose-directed water; and that will be undamaged by the external formation of ice on the enclosure. |

Figure 4: Panel Mounting Dimensions

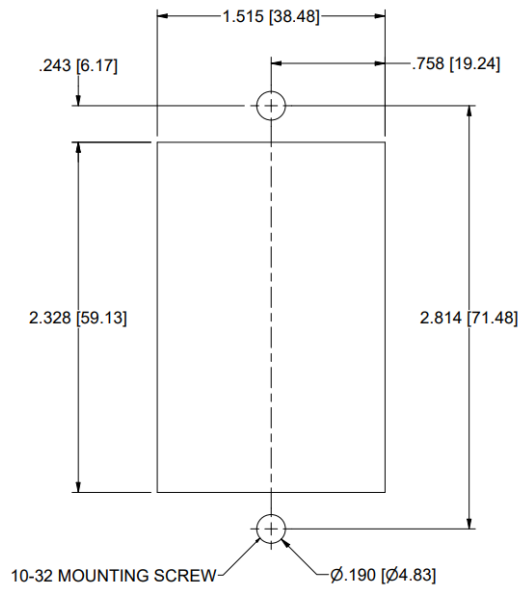
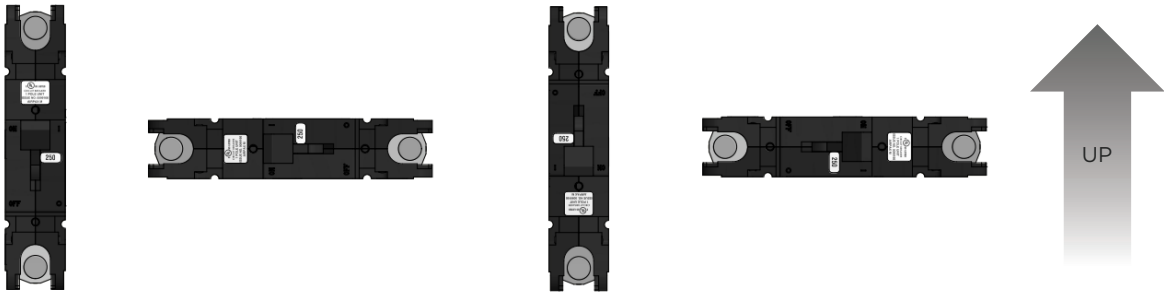
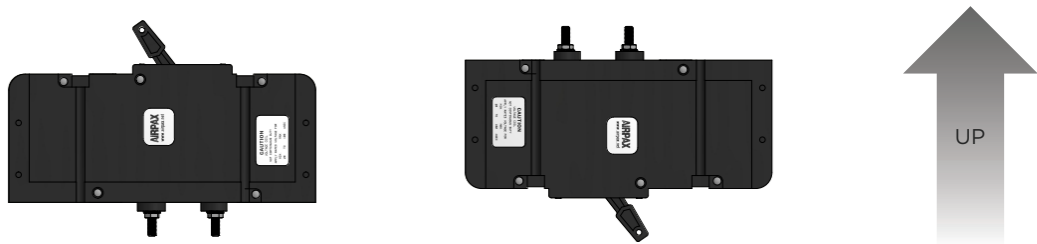

Figure 5: DC Circuit Breaker Orientations

Permitted



NOT Permitted



3.2 Battery Environment and Mounting orientation

- The Battery needs to be mounted in an environment that does not receive direct sunlight, pressurized water or road debris.
- To avoid power interruption, you may need to consider controlling the ambient operating temperature.
- Mount the Battery in an upright position, i.e. black lid faces up.
 - Other orientations are NOT permitted and will void the warranty.

3.3 Battery Power Terminals (see Figure 8 on page 13 for diagram)

- Connect the Battery Negative Terminal to your DC negative busbar or inverter.
 - Use 2/0 wire and 2/0 3/8" stud ring terminals.
 - The battery negative wire is recommended to be 3-5 feet recommended.
 - Torque the battery negative power terminal to 108-132in-lbs (12.2-14.9N-m).
- Connect the Battery Positive Terminal to either one of the power terminals on the circuit breaker (Figure 6, point A).
 - Use 2/0 wire and 2/0 3/8" stud ring terminals.
 - The battery positive wire (between battery and circuit breaker) is recommended to be 3-5 feet recommended.
 - Torque the battery positive power terminal to 108-132in-lbs (12.2-14.9N-m).
 - Torque the 3/8" nuts on the circuit breaker to 220-230 in-lbs (24.9-26.0N-m).
 - Never stack ring terminals.
 - Never place the stainless-steel washer or lock-washer between the conductive power terminal and ring terminal lug (see Figure 7).
- Connect the opposite end circuit breaker power terminal to your DC positive busbar or inverter.
 - Use 2/0 wire and 2/0 3/8" stud ring terminals.
 - The battery positive and negative wires are recommended to be 3-5 feet recommended.

3.4 Accessory Harness

- Connect the 2x #10 stud ring terminals to the Circuit Breaker (Figure 6, point B).
 - Torque the 2x 5/16" nuts to 26in-lbs (2.9N-m).
- Connect the Accessory Harness to the Accessory Connector on the Battery (Figure 1, point C).

3.5 Initial Charge Cycle

- Initially the system must be FULLY charged once to calibrate the Battery. Please read and follow the next section to perform this.

Figure 6: Terminals

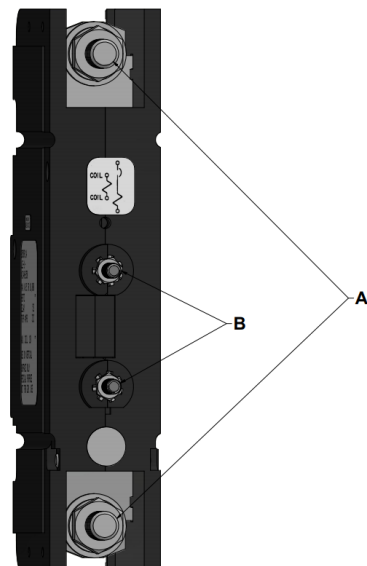

Figure 7: Terminal Connections

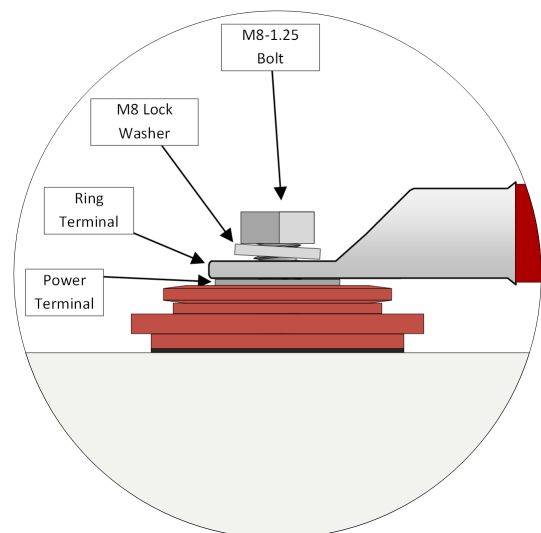
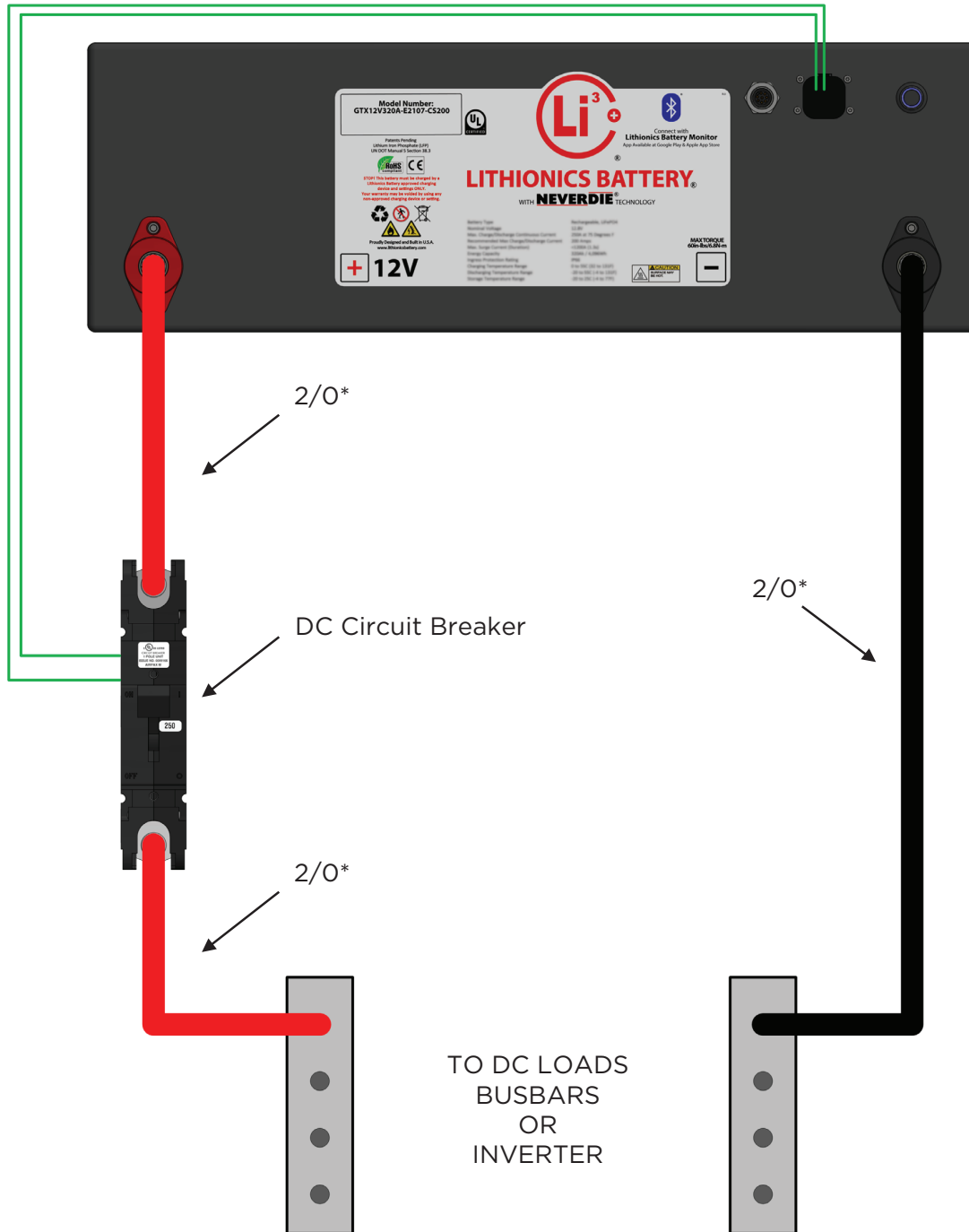

Figure 8: Wiring Diagram



**3-5 feet total length recommended*

4. SYSTEM OPERATION

4.1 Powering the System On

- Ensure that the circuit breaker lever is in the ON position.
- Short-press the Power switch for 1 second.
 - The switch will illuminate once power is enabled.
 - Check that there is voltage at the Power Terminals with a voltmeter.

4.2 Powering the System Off

- Long-press the Power switch for 3 seconds.
 - The switch will cease to illuminate once power is disabled.
 - Check that there is 0V at the output terminals with a voltmeter.
 - NOTE: During normal operation, the circuit breaker can be left in the ON position when powering off the battery. For maintenance/storage turn the circuit breaker OFF.

4.3 Charging

- The charging device(s) connected to the Lithium Battery System must be programmed as per Table 1.
- Charging may be performed at any time the system is powered On.
 - NOTE: The Battery will disconnect power if the voltage, amperage, or temperature limits are exceeded during charging.
 - Only use a Lithionics Battery approved charging source. Please contact Lithionics Battery for charger approval.

4.4 Initial Charging Cycle

- The initial charging cycle is required as it calibrates the Battery for accurate State of Charge percentage (SoC) monitoring.
- During the initial charging cycle, the system must reach a voltage level that is equal to the Standard Full Charging Voltage indicated in Table 1 on page 9.
- Enable the charging device(s) so that they may complete a charge cycle. It is recommended to not have any discharge loads active during the initial charging cycle, especially towards the end of charging.

4.5 Discharging

- Discharging may be performed at any time the system is powered On.
 - NOTE: The Battery will disconnect power if the voltage, amperage, or temperature limits are exceeded during discharging.
- The NeverDie feature allows the system to have a “reserve” amount of energy left in the battery. Once the system is discharged to 12.0V or 10% State of Charge (SoC), whichever comes first, power will be disabled to leave a “reserve” amount of energy still left in the battery.
- To enable the remaining reserve energy of the system, short-press the Power switch for 1 second.
 - NOTE: Once the reserve range is enabled the battery should be charged as soon as possible.
 - WARNING: If the reserve energy is used and the battery is left in a deeply discharged state without immediate charging, the battery will become permanently damaged.

4.6 System Storage Procedure

- Storing your battery at the correct specifications is important as it keeps the battery in the healthiest state possible for the fastest deployment when needed.
- If the Lithium Battery System will not be in use for more than 2 weeks, it is recommended to enable system storage.
- Storage mode is simply a fully charged system in the Powered Off state.
- To enable System Storage:
 - Perform a full charge cycle, ensure that the System voltage reaches the Standard Full Charging Voltage indicated in Table 1 on page 9.
 - Power off the System, long-press the Power switch for 3 seconds. Check that the switch is no longer illuminated. Check that there is 0V at the Power Terminals with a voltmeter.

Table 4: Battery Storage

| | | |
|--------------------------------------|--|------------------------------|
| Storage Temperature & Humidity Range | < 1 Month | -4~95°F (-20~35°C), 45~75%RH |
| | < 3 Months | 14~86°F (-10~30°C), 45~75%RH |
| Long Term Storage | If the battery needs to be stored for > 3 months the voltage should be 13.2V (50% state-of-charge) and stored at the recommended storage specifications shown above. Additionally, the battery needs at least one charge & discharge cycle every six months. | |
| Self-Discharge Rate | ≤ 3% per month | |

Storage conditions < 3 months:

1. Fully charge the battery.
2. Turn the battery **OFF** by the Power/Reset switch.
3. Store the battery in an environment according to the specifications shown above.

Storage conditions > 3 months:

1. Reduce the battery SOC to 13.2V which is 50% ±10% SOC.
2. Turn the battery **OFF** via the Power/Reset switch.
3. Store the battery in an environment according to the specifications shown in table 3 above.
4. Every 6 months charge the battery to 100% SOC, then discharge the battery to LVC, then charge it to 50% ±10% SOC.

NOTE: For further system installation and operation please refer to the [GTX12V320A-E2107-CS200-UL User Guide](https://lithionics.com) available on <https://lithionics.com>.

CONTACT INFORMATION

For technical or warranty support please first contact the dealer where the system was purchased.

For further troubleshooting, please contact Lithionics directly at [Support:Home](#).